

U.S. TSUBAKI POWER-LOCK®

DOUBLE TORQUE SERIES

AD Metric Series

Installing to hubs with a guide portion

when $L_t < B < 2\ell$
(See Installation Example B)

Installing to hubs without a guide portion

(See Installation Example C)

D_N is the minimum hub diameter required to tolerate P' or the pressure exerted from within the hub.

<EXAMPLE> Hub Material Yield Point = 35500 psi
PL030X055AD = 3.229" min. hub diameter

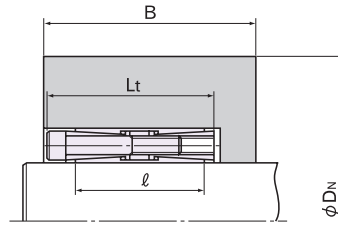

Installation Example B
When installing to hubs with a guide portion, the hub configuration coefficient is as follows: $K_3 = 1.0$

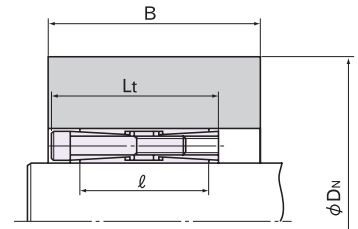

Installation Example C
When installing to hubs without a guide portion, the hub configuration coefficient is as follows: $K_3 = 1.0$

Min. Hub Dia. (D_N in inches)

Model Number	Hub Contact Pressure P' (psi)	Yield Point and Material examples													
		147 Mpa	176 Mpa	206 Mpa	225 Mpa	245 Mpa	274 Mpa	294 Mpa	343 Mpa	392 Mpa	441 Mpa				
		21300 psi	25500 psi	29900 psi	32600 psi	35500 psi	39700 psi	42600 psi	49700 psi	56900 psi	64000 psi				
		1010	304SS	316SS	1015	1118	1020	1030	1035	1040	1144	4140	1045	1055	
PL019X047 AD	13924	4.039	3.412	3.066	2.919	2.799	2.668	2.597	2.467	2.376	2.309				
PL020X047 AD	13924	4.039	3.412	3.066	2.919	2.799	2.668	2.597	2.467	2.376	2.309				
PL022X047 AD	13924	4.039	3.412	3.066	2.919	2.799	2.668	2.597	2.467	2.376	2.309				
PL024X050 AD	14939	4.692	3.848	3.410	3.228	3.082	2.923	2.838	2.683	2.576	2.497				
PL025X050 AD	14939	4.692	3.848	3.410	3.228	3.082	2.923	2.838	2.683	2.576	2.497				
PL028X055 AD	13489	4.565	3.898	3.522	3.361	3.229	3.083	3.005	2.860	2.758	2.682				
PL030X055 AD	13489	4.565	3.898	3.522	3.361	3.229	3.083	3.005	2.860	2.758	2.682				
PL032X060 AD	14649	5.485	4.540	4.039	3.830	3.662	3.478	3.379	3.200	3.075	2.982				
PL035X060 AD	14649	5.485	4.540	4.039	3.830	3.662	3.478	3.379	3.200	3.075	2.982				
PL038X065 AD	12764	5.107	4.432	4.039	3.868	3.727	3.570	3.485	3.327	3.216	3.133				
PL040X065 AD	12764	5.107	4.432	4.039	3.868	3.727	3.570	3.485	3.327	3.216	3.133				
PL042X075 AD	15664	7.550	6.034	5.285	4.981	4.740	4.479	4.341	4.091	3.918	3.791				
PL045X075 AD	15664	7.550	6.034	5.285	4.981	4.740	4.479	4.341	4.091	3.918	3.791				
PL048X080 AD	14649	7.313	6.053	5.386	5.107	4.882	4.637	4.506	4.266	4.010	3.977				
PL050X080 AD	14649	7.313	6.053	5.386	5.107	4.882	4.637	4.506	4.266	4.010	3.977				
PL055X085 AD	13779	7.219	6.121	5.511	5.250	5.038	4.805	4.679	4.447	4.285	4.165				
PL060X090 AD	15954	9.338	7.376	6.429	6.048	5.746	5.422	5.250	4.941	4.728	4.572				
PL065X095 AD	12909	7.545	6.528	5.939	5.683	5.473	5.239	5.112	4.878	4.712	4.589				
PL070X110 AD	16535	12.179	9.366	8.077	7.568	7.169	6.744	6.520	6.118	5.843	5.642				
PL075X115 AD	15809	11.751	9.338	8.159	7.683	7.305	6.898	6.682	6.293	6.024	5.827				
PL080X120 AD	16535	13.287	10.218	8.811	8.256	7.821	7.357	7.113	6.674	6.374	6.155				
PL085X125 AD	15809	12.773	10.150	8.868	8.351	7.940	7.498	7.263	6.840	6.548	6.334				
PL090X130 AD	16535	14.394	11.069	9.545	8.944	8.473	7.970	7.706	7.230	6.905	6.668				
PL095X135 AD	15954	14.008	11.064	9.643	9.071	8.619	8.133	7.876	7.411	7.091	6.857				
PL100X145 AD	15664	14.597	11.666	10.218	9.631	9.163	8.660	8.392	7.908	7.575	7.330				
PL110X155 AD	15954	16.083	12.703	11.071	10.415	9.896	9.338	9.042	8.509	8.142	7.873				
PL120X165 AD	17260	20.022	14.778	12.555	11.702	11.041	10.344	9.979	9.329	8.887	8.567				
PL130X180 AD	16099	18.971	14.891	12.945	12.166	11.551	10.891	10.542	9.913	9.481	9.165				
PL140X190 AD	17550	24.016	17.383	14.672	13.644	12.851	12.019	11.586	10.814	10.292	9.913				
PL150X200 AD	17840	26.410	18.702	15.677	14.544	13.675	12.767	12.296	11.460	10.895	10.486				
PL160X210 AD	17840	27.731	19.637	16.461	15.271	14.359	13.406	12.911	12.033	11.440	11.011				
PL170X225 AD	15954	23.346	18.440	16.072	15.119	14.365	13.555	13.126	12.352	11.819	11.429				
PL180X235 AD	16390	25.585	19.816	17.135	16.073	15.237	14.344	13.874	13.027	12.447	12.024				
PL190X250 AD	16390	27.218	21.081	18.229	17.098	16.209	15.260	14.759	13.859	13.242	12.792				
PL200X260 AD	15664	26.174	20.919	18.323	17.269	16.431	15.528	15.049	14.181	13.582	13.143				
PL220X285 AD	17115	33.918	25.262	21.530	20.089	18.970	17.787	17.167	16.061	15.308	14.761				
PL240X305 AD	17405	37.761	27.607	23.379	21.766	20.519	19.207	18.522	17.302	16.475	15.874				
PL260X325 AD	13199	26.378	22.678	20.563	19.649	18.900	18.071	17.621	16.792	16.208	15.775				
PL280X355 AD	17115	42.249	31.467	26.818	25.024	23.629	22.155	21.384	20.006	19.068	18.387				
PL300X375 AD	17840	49.519	35.067	29.394	27.270	25.641	23.939	23.055	21.487	20.428	19.662				